



TOWN OF NEWBURGH

Crossroads of the Northeast

ZONING BOARD OF APPEALS
21 Hudson Valley Professional Plaza
Newburgh, NY 12550



OFFICE OF ZONING BOARD
DARRIN SCALZO, CHAIRMAN
SIOBHAN JABLESNIK, SECRETARY

TELEPHONE 845-566-4901
FAX LINE 845-564-7802

APPLICATION

DATED: 11/8/2024

TO: THE ZONING BOARD OF APPEALS
THE TOWN OF NEWBURGH, NEW YORK 12550

I (WE) STEVEN J. WAGNER PRESENTLY
RESIDING AT NUMBER 13 TOMS LANE, NEWBURGH, N.Y. 12550
TELEPHONE NUMBER 845-344-7134

HEREBY MAKE APPLICATION TO THE ZONING BOARD OF APPEALS FOR THE FOLLOWING:

- USE VARIANCE
- AREA VARIANCE (S)
- INTERPRETATION OF THE ORDINANCE
- SPECIAL PERMIT

1. LOCATION OF THE PROPERTY:

21-1-1 (TAX MAP DESIGNATION)
70 FROZEN RIDGE RD (STREET ADDRESS)
R-2 (ZONING DISTRICT)

2. PROVISION OF THE ZONING LAW APPLICABLE, (INDICATE THE SECTION AND SUB-SECTION OF THE ZONING LAW APPLICABLE BY NUMBER; DO NOT QUOTE THE LAW).

185-19-C-1 (FRONT YARD)
185-19-C-1 (ONE SIDE YARD)
185-19-C-1 (COMBINED SIDE YARDS)

3. IF VARIANCE TO THE ZONING LAW IS REQUESTED:

a) APPEAL IS MADE FROM DISAPPROVAL BY THE TOWN BUILDING INSPECTOR OR BUILDING PERMIT APPLICATION. SEE ACCOMPANYING NOTICE DATED:

b) OR DENIAL (REFERRAL) BY THE PLANNING BOARD OF THE TOWN OF NEWBURGH OF AN APPLICATION TO THE BOARD, SEE ACCOMPANYING NOTICE DATED:

4. DESCRIPTION OF VARIANCE SOUGHT: FRONT YARD VARIANCE OF 3.4 FEET
SIDE YARD VARIANCE OF 1.1 FEET, COMBINED SIDE YARD VARIANCE
OF 3.1 FEET

5. IF A USE VARIANCE IS REQUESTED: STRICT APPLICATION OF THE ZONING LAW WOULD PRODUCE UNNECESSARY HARDSHIP IN THAT:

a) UNDER APPLICABLE ZONING REGULATIONS THE APPLICANT IS DEPRIVED OF ALL ECONOMIC USE OR BENEFIT FROM THE PROPERTY IN QUESTION BECAUSE:
NO WORK CAN PROCEED BECAUSE A BUILDING PERMIT WAS DISAPPROVED BECAUSE OF EXISTING NON-CONFORMING SET BACKS OF AN EXISTING HOUSE.
(ATTACH WITH THIS APPLICATION COMPETENT FINANCIAL EVIDENCE ESTABLISHING SUCH DEPRIVATION)

b) THE HARDSHIP IS UNIQUE AND DOES NOT APPLY TO A SUBSTANTIAL PORTION OF THE DISTRICT OR NEIGHBORHOOD BECAUSE:
THE HOUSE IS EXISTING + WAS PROBABLY BUILT BEFORE ZONING

c) THE VARIANCE WOULD NOT ALTER THE ESSENTIAL CHARACTER OF THE NEIGHBORHOOD BECAUSE:
THE HOUSE IS EXISTING + LOCATED IN AN EXISTING NEIGHBORHOOD

d) THE HARDSHIP HAS NOT BEEN SELF-CREATED BECAUSE:
BECAUSE THE HOUSE IS EXISTING, PROBABLY BUILT BEFORE ZONING

6. IF AN AREA VARIANCE IS REQUESTED:

- a) THE VARIANCE WILL NOT PRODUCE AN UNDESIRABLE CHANGE IN THE CHARACTER OF THE NEIGHBORHOOD OR A DETRIMENT TO NEARBY PROPERTIES BECAUSE:

I AM NOT CHANGING THE SIZE OF
THE HOUSE OR ADDING ANYTHING TO IT.

- b) THE BENEFIT SOUGHT BY THE APPLICANT CAN NOT BE ACHIEVED BY SOME METHOD, FEASIBLE FOR THE APPLICANT TO PURSUE, OTHER THAN AN AREA VARIANCE, BECAUSE:

THE HOUSE CANNOT BE MOVED

- c) THE REQUESTED AREA VARIANCE IS NOT SUBSTANTIAL BECAUSE:

ONLY NEEDED 3'6" FOR FRONT YARD
AND 3'3" FOR COMBINED SIDE YARDS

- d) THE PROPOSED VARIANCE WILL NOT HAVE AN ADVERSE EFFECT OR IMPACT ON THE PHYSICAL OR ENVIRONMENTAL CONDITIONS IN THE NEIGHBORHOOD OR DISTRICT BECAUSE:

I AM NOT CHANGING THE TOPOGRAPHY
OR THE LOCATION OF THE HOUSE OR
ADDING TO THE PROPERTY OR HOUSE

- e) THE HARDSHIP HAS NOT BEEN SELF-CREATED BECAUSE:

THE PROPERTY WAS PURCHASED AS IS
WITH SOME DEMO TO REMOVE
UNSAFE AREAS

7. ADDITIONAL REASONS (IF PERTINENT):

PETITIONER (S) SIGNATURE

STATE OF NEW YORK: COUNTY OF ORANGE:

SWORN TO THIS _____ DAY OF _____ 20_____

NOTARY PUBLIC

NOTE: NYS GML Section 239-m (3) for proposed actions that are within 500 feet of the properties or thresholds listed in the statute the Zoning Board of Appeals is required to send a copy of the complete application to the Orange County Department of Planning to be reviewed prior to Zoning Board of Appeals decision. And also NYS GML Section 239-NN requires notification for any proposed actions, to the Municipal Clerk, within 500 feet of the Border of that adjoining County, Town or City.

(ALL MATERIALS REGARDING THE APPLICATION MUST BE SUBMITTED TO THE ZONING BOARD OFFICE FOR REVIEW NO LATER THAN 13 DAYS PRIOR TO THE HEARING DATE OR THEY MAY NOT BE CONSIDERED THE NIGHT OF THE MEETING).

(NOTE: BOARD MEMBERS MAKE SITE VISITS TO ALL THE PROPERTIES)

*Short Environmental Assessment Form
Part 1 - Project Information*

Instructions for Completing

Part 1 - Project Information. The applicant or project sponsor is responsible for the completion of Part 1. Responses become part of the application for approval or funding, are subject to public review, and may be subject to further verification. Complete Part 1 based on information currently available. If additional research or investigation would be needed to fully respond to any item, please answer as thoroughly as possible based on current information.

Complete all items in Part 1. You may also provide any additional information which you believe will be needed by or useful to the lead agency; attach additional pages as necessary to supplement any item.

Part 1 - Project and Sponsor Information			
Name of Action or Project: AREA VARIANCE			
Project Location (describe, and attach a location map): 70 FROZEN RIDGE RD., NEWBURGH NY 12550			
Brief Description of Proposed Action: NEED A VARIANCE FOR FRONT YARD AND SIDE YARDS FOR AN EXISTING HOUSE BUILT IN 1918. POSSIBLY BEFORE ZONING REGULATIONS WERE IMPLEMENTED IN THE TOWN			
Name of Applicant or Sponsor: STEVEN J. WAGNER		Telephone: 845-344-7134	CROSS CUTTING@YAHOO.COM
Address: 13 TOMS LANE		E-Mail:	
City/PO: NEWBURGH		State: NY	Zip Code: 12550
1. Does the proposed action only involve the legislative adoption of a plan, local law, ordinance, administrative rule, or regulation? If Yes, attach a narrative description of the intent of the proposed action and the environmental resources that may be affected in the municipality and proceed to Part 2. If no, continue to question 2.			NO YES <input checked="" type="checkbox"/> <input type="checkbox"/>
2. Does the proposed action require a permit, approval or funding from any other governmental Agency? If Yes, list agency(s) name and permit or approval:			NO YES <input type="checkbox"/> <input checked="" type="checkbox"/>
TOWN OF NEWBURGH BUILDING PERMIT			
3.a. Total acreage of the site of the proposed action?		<u>0.57</u> acres	
b. Total acreage to be physically disturbed?		<u>0</u> acres	
c. Total acreage (project site and any contiguous properties) owned or controlled by the applicant or project sponsor?		<u>0.57</u> acres	
4. Check all land uses that occur on, adjoining and near the proposed action.			
<input type="checkbox"/> Urban <input type="checkbox"/> Rural (non-agriculture) <input type="checkbox"/> Industrial <input type="checkbox"/> Commercial <input checked="" type="checkbox"/> Residential (suburban) <input type="checkbox"/> Forest <input type="checkbox"/> Agriculture <input type="checkbox"/> Aquatic <input type="checkbox"/> Other (specify): _____ <input type="checkbox"/> Parkland			

5. Is the proposed action, a. A permitted use under the zoning regulations?	NO	YES	N/A
	<input type="checkbox"/>	<input checked="" type="checkbox"/>	<input type="checkbox"/>
b. Consistent with the adopted comprehensive plan?	<input type="checkbox"/>	<input checked="" type="checkbox"/>	<input type="checkbox"/>
6. Is the proposed action consistent with the predominant character of the existing built or natural landscape?	NO	YES	
	<input type="checkbox"/>	<input checked="" type="checkbox"/>	
7. Is the site of the proposed action located in, or does it adjoin, a state listed Critical Environmental Area? If Yes, identify: _____	NO	YES	
	<input checked="" type="checkbox"/>	<input type="checkbox"/>	
8. a. Will the proposed action result in a substantial increase in traffic above present levels?	NO	YES	
	<input checked="" type="checkbox"/>	<input type="checkbox"/>	
b. Are public transportation service(s) available at or near the site of the proposed action?	<input checked="" type="checkbox"/>	<input type="checkbox"/>	
c. Are any pedestrian accommodations or bicycle routes available on or near site of the proposed action?	<input checked="" type="checkbox"/>	<input type="checkbox"/>	
9. Does the proposed action meet or exceed the state energy code requirements? If the proposed action will exceed requirements, describe design features and technologies: _____	NO	YES	
	<input type="checkbox"/>	<input checked="" type="checkbox"/>	
10. Will the proposed action connect to an existing public/private water supply? If No, describe method for providing potable water: <u>PRIVATE WELL</u>	NO	YES	
	<input checked="" type="checkbox"/>	<input type="checkbox"/>	
11. Will the proposed action connect to existing wastewater utilities? If No, describe method for providing wastewater treatment: <u>PRIVATE SEPTIC SYSTEM</u>	NO	YES	
	<input checked="" type="checkbox"/>	<input type="checkbox"/>	
12. a. Does the site contain a structure that is listed on either the State or National Register of Historic Places? b. Is the proposed action located in an archeological sensitive area?	NO	YES	
	<input checked="" type="checkbox"/>	<input type="checkbox"/>	
	<input checked="" type="checkbox"/>	<input type="checkbox"/>	
13. a. Does any portion of the site of the proposed action, or lands adjoining the proposed action, contain wetlands or other waterbodies regulated by a federal, state or local agency? b. Would the proposed action physically alter, or encroach into, any existing wetland or waterbody? If Yes, identify the wetland or waterbody and extent of alterations in square feet or acres: _____	NO	YES	
	<input checked="" type="checkbox"/>	<input type="checkbox"/>	
	<input checked="" type="checkbox"/>	<input type="checkbox"/>	
14. Identify the typical habitat types that occur on, or are likely to be found on the project site. Check all that apply: <input type="checkbox"/> Shoreline <input type="checkbox"/> Forest <input type="checkbox"/> Agricultural/grasslands <input type="checkbox"/> Early mid-successional <input type="checkbox"/> Wetland <input type="checkbox"/> Urban <input checked="" type="checkbox"/> Suburban			
15. Does the site of the proposed action contain any species of animal, or associated habitats, listed by the State or Federal government as threatened or endangered?	NO	YES	
	<input checked="" type="checkbox"/>	<input type="checkbox"/>	
16. Is the project site located in the 100 year flood plain?	NO	YES	
	<input checked="" type="checkbox"/>	<input type="checkbox"/>	
17. Will the proposed action create storm water discharge, either from point or non-point sources? If Yes, a. Will storm water discharges flow to adjacent properties? <input type="checkbox"/> NO <input type="checkbox"/> YES b. Will storm water discharges be directed to established conveyance systems (runoff and storm drains)? If Yes, briefly describe: _____	NO	YES	
	<input checked="" type="checkbox"/>	<input type="checkbox"/>	

18. Does the proposed action include construction or other activities that result in the impoundment of water or other liquids (e.g. retention pond, waste lagoon, dam)? If Yes, explain purpose and size: _____ _____ _____	NO	YES
	<input checked="" type="checkbox"/>	<input type="checkbox"/>
19. Has the site of the proposed action or an adjoining property been the location of an active or closed solid waste management facility? If Yes, describe: _____ _____ _____	NO	YES
	<input checked="" type="checkbox"/>	<input type="checkbox"/>
20. Has the site of the proposed action or an adjoining property been the subject of remediation (ongoing or completed) for hazardous waste? If Yes, describe: _____ _____ _____	NO	YES
	<input checked="" type="checkbox"/>	<input type="checkbox"/>
I AFFIRM THAT THE INFORMATION PROVIDED ABOVE IS TRUE AND ACCURATE TO THE BEST OF MY KNOWLEDGE		
Applicant/sponsor name: <u>STEVEN J. WAGNER</u>	Date: <u>11/8/2024</u>	
Signature: <u>Steven J. Wagner</u>		

Agency Use Only [If applicable]

Project:

Date:

*Short Environmental Assessment Form
Part 2 - Impact Assessment*

Part 2 is to be completed by the Lead Agency.

Answer all of the following questions in Part 2 using the information contained in Part 1 and other materials submitted by the project sponsor or otherwise available to the reviewer. When answering the questions the reviewer should be guided by the concept "Have my responses been reasonable considering the scale and context of the proposed action?"

	No, or small impact may occur	Moderate to large impact may occur
1. Will the proposed action create a material conflict with an adopted land use plan or zoning regulations?	<input type="checkbox"/>	<input type="checkbox"/>
2. Will the proposed action result in a change in the use or intensity of use of land?	<input type="checkbox"/>	<input type="checkbox"/>
3. Will the proposed action impair the character or quality of the existing community?	<input type="checkbox"/>	<input type="checkbox"/>
4. Will the proposed action have an impact on the environmental characteristics that caused the establishment of a Critical Environmental Area (CEA)?	<input type="checkbox"/>	<input type="checkbox"/>
5. Will the proposed action result in an adverse change in the existing level of traffic or affect existing infrastructure for mass transit, biking or walkway?	<input type="checkbox"/>	<input type="checkbox"/>
6. Will the proposed action cause an increase in the use of energy and it fails to incorporate reasonably available energy conservation or renewable energy opportunities?	<input type="checkbox"/>	<input type="checkbox"/>
7. Will the proposed action impact existing:		
a. public / private water supplies?	<input type="checkbox"/>	<input type="checkbox"/>
b. public / private wastewater treatment utilities?	<input type="checkbox"/>	<input type="checkbox"/>
8. Will the proposed action impair the character or quality of important historic, archaeological, architectural or aesthetic resources?	<input type="checkbox"/>	<input type="checkbox"/>
9. Will the proposed action result in an adverse change to natural resources (e.g., wetlands, waterbodies, groundwater, air quality, flora and fauna)?	<input type="checkbox"/>	<input type="checkbox"/>
10. Will the proposed action result in an increase in the potential for erosion, flooding or drainage problems?	<input type="checkbox"/>	<input type="checkbox"/>
11. Will the proposed action create a hazard to environmental resources or human health?	<input type="checkbox"/>	<input type="checkbox"/>

Agency Use Only [If applicable]

Project:

Date:

Short Environmental Assessment Form Part 3 Determination of Significance

For every question in Part 2 that was answered "moderate to large impact may occur", or if there is a need to explain why a particular element of the proposed action may or will not result in a significant adverse environmental impact, please complete Part 3. Part 3 should, in sufficient detail, identify the impact, including any measures or design elements that have been included by the project sponsor to avoid or reduce impacts. Part 3 should also explain how the lead agency determined that the impact may or will not be significant. Each potential impact should be assessed considering its setting, probability of occurring, duration, irreversibility, geographic scope and magnitude. Also consider the potential for short-term, long-term and cumulative impacts.

Check this box if you have determined, based on the information and analysis above, and any supporting documentation, that the proposed action may result in one or more potentially large or significant adverse impacts and an environmental impact statement is required.

Check this box if you have determined, based on the information and analysis above, and any supporting documentation, that the proposed action will not result in any significant adverse environmental impacts.

Name of Lead Agency

Date

Print or Type Name of Responsible Officer in Lead Agency

Title of Responsible Officer

Signature of Responsible Officer in Lead Agency

Signature of Preparer (if different from Responsible Officer)



TOWN OF NEWBURGH

~Crossroads of the Northeast~

CODE COMPLIANCE DEPARTMENT
21 HUDSON VALLEY PROFESSIONAL PLAZA
NEWBURGH, NEW YORK 12550

TELEPHONE 845-564-7801
FAX LINE 845-564-7802

NOTICE OF DISAPPROVAL OF BUILDING PERMIT APPLICATION

Date: 11/05/2024

Application No. 21-0912

To: Crosscut Construction, Inc.
13 Toms Lane
Newburgh, NY 12550

SBL: 21-1-1
ADDRESS: 70 Frozen Ridge Rd

ZONE: R2

PLEASE TAKE NOTICE that your application dated 08/11/2021 for permit to Single family on the premises located at 70 Frozen Ridge Rd is returned herewith and disapproved on the following grounds:

Town of Newburgh Municipal Code:

- 1) 185-19-C-1: Shall not increase the degree of non-conformity. (front yard)
- 2) 185-19-C-1: Shall not increase the degree of non-conformity. (one side yard)
- 3) 185-19-C-1: Shall not increase the degree of non-conformity. (combined side yards)



Joseph Mattina

Cc: Town Clerk & Assessor (500')
File

Town of Newburgh Code Compliance

OWNER INFORMATION ***BUILT WITH OUT A PERMIT*** **YES / NO**

NAME: CROSSCUT CONSTRUCTION **Application #** 21-0912

ADDRESS: 13 TOMS LANE NEWBURGH NY 12550

PROJECT INFORMATION: **AREA VARIANCE** USE VARIANCE

TYPE OF STRUCTURE: TOTAL REBUILD @ 70 FROZEN RIDGE RD

SBL: 21-1-1 **ZONE:** R-2 **ZBA Application #** _____

TOWN WATER: YES / **NO** **TOWN SEWER:** YES / **NO** N/A

	MINIMUM	EXISTING	PROPOSED	VARIANCE	VARIANCE PERCENTAGE
LOT AREA					
LOT WIDTH					
LOT DEPTH					
FRONT YARD	50'	46.6'	INCREASING DEGREE NON CONFORMITY		
ONE REAR YARD	30'	28.9'	INCREASING DEGREE NON CONFORMITY		
COMBINED SIDE YARD	80'	76.9'	INCREASING DEGREE NON CONFORMITY		
MAX. BUILDING HEIGHT					
BUILDING COVERAGE					
SURFACE COVERAGE					

INCREASING DEGREE OF NON-CONFORMITY - 185-19-C-1 **YES X 3**
 2 OR MORE FRONT YARDS FOR THIS PROPERTY YES / NO
 CORNER LOT - 185-17-A YES / NO

ACCESSORY STRUCTURE:

GREATER THEN 1000 S.F. OR BY FORMULA - 185-15-A-4 YES / NO
 FRONT YARD - 185-15-A YES / NO
 STORAGE OF MORE THEN 4 VEHICLES YES / NO
 HEIGHT MAX. 15 FEET - 185-15-A-1 YES / NO
 10% MAXIMUM YARD COVERAGE - 185-15-A-3 YES / NO

NOTES:
THE BUILDING IS EXISTING NON-CONFORMING

REVIEWED BY: Joseph Mattina **DATE:** 5-Nov-24



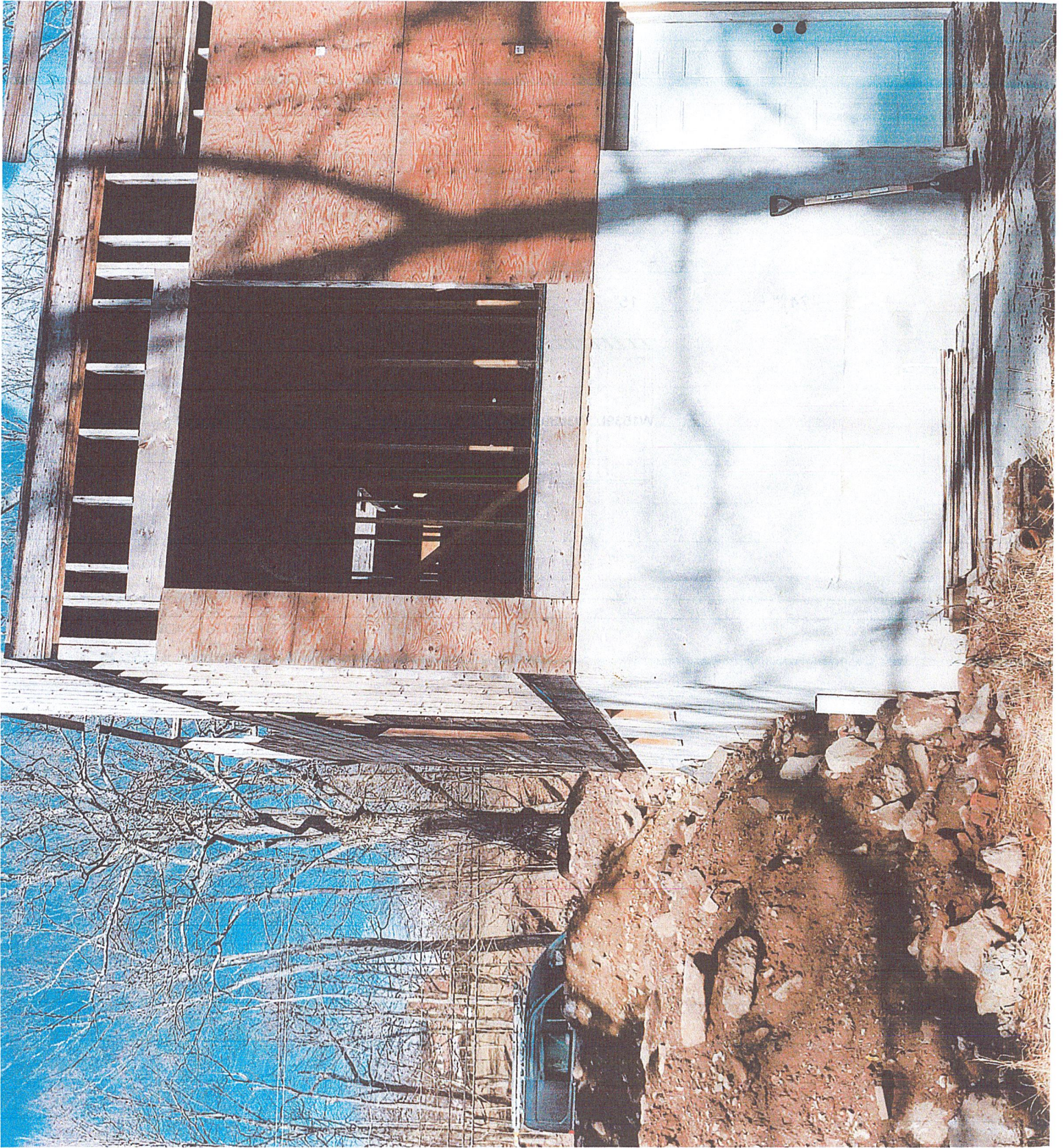





**AFFIDAVIT OF POSTING(S) OF
NOTICE OF PUBLIC HEARING
AT THE PROPERTY**

STATE OF NEW YORK: COUNTY OF ORANGE:

I, STEVEN J. WAGNER, being duly sworn, depose and say that I did on or before

November 12, 2024, post and will thereafter maintain at

70 Frozen Ridge Rd 21-1-1 R2 Zone in the Town of Newburgh, New York, at or near the front property line(s) and within view of each fronting street a copy(ies) of the Notice of Public Hearing, which notice was in the form attached hereto.

The applicant shall maintain and update notice(s) (with amended information if there is any change to the information contained in the original Notice of Hearing) until after the Public Hearing is closed. The Notice must then be removed and property disposed of within ten (10) days of the close of the Public Hearing. Failure to follow the required procedure may result in the Public Hearing being held open for additional time.

Steven J. Wagner

Sworn to before me this 12th

day of November, 2024.

Rosicel Baker

