

NEW ROAD

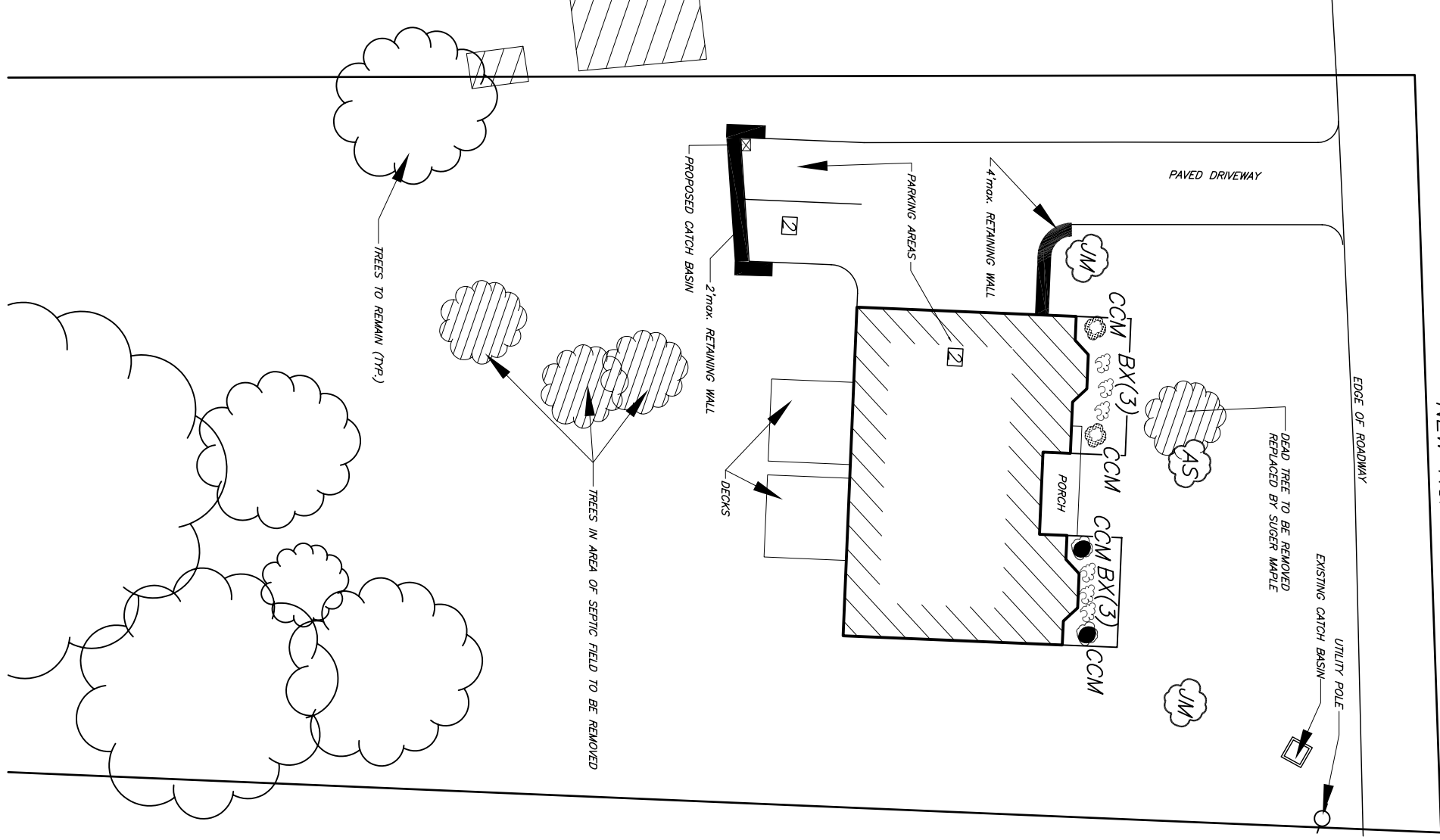

LANDSCAPE NOTES:

1. ALL PLANT BEDS SHALL BE MOUND SIGHTLY AND WHERE INDICATED BERMED.
2. MULCHED BEDS SHALL BE PROVIDED AROUND SHRUB PLANTINGS, AND MULCHED RINGS SHALL BE PROVIDED AROUND TREE PLANTINGS. SHALL BE WARPANTED FOR A PERIOD OF 2 YEARS. IN ACCORDANCE WITH THE DRAWINGS AND SPECIFICATIONS. ALL PLANTS MISSING MORE THAN 25% DEAD WHICH DO NOT DEVELOP FROM PLANTING STOCK THAT APPEAR UNHEALTHY OR UNSIGHTLY AND/OR HAVE LOST THE NATURAL SHAPE DUE TO DEAD BRANCHES. ANY TREE THAT LOSTS THE MAIN LEADER SHALL BE REPLACED. PLANT MATERIAL SHALL BE INSPECTED BY THE LANDSCAPE ARCHITECTURAL CONSULTANT FOR THE TOWN OF NEWBURGH UPON THE COMPLETION OF WORK AND DURING EVERY GROWING SEASON FOR 2 YEARS. PLANTS THAT NEED REPLACEMENT SHALL BE NOTED ON AN INSPECTION REPORT AND MUST BE REPLACED WITHIN 2 MONTHS OF RECEIPT OF THE INSPECTION REPORT OR SEASON.
4. ALL PLANTS TO MEET CURRENT AMERICAN ASSOCIATION OF NURSERMEN STANDARDS.
5. NO TREE SHALL BE PLANTED WITHIN TEN FEET OF ANY UNDERGROUND UTILITY.
6. ALL DISTURBED AREAS NOT USED FOR BUILDINGS, DRIVES, PARKING AREAS OR LANDSCAPED AREAS SHALL BE SEDED AS PER SEEDING SPECIFICATIONS.
7. SCARIFY EXISTING SOIL TO A DEPTH OF 12" IN ALL PROPOSED LANDSCAPE BEDS. INSTALL A MINIMUM OF 6" OF TOPSOIL, AVAILABLE FROM ON-SITE STOCKPILES. TOPSOIL MUST CONTAIN A MINIMUM OF 25% ORGANIC MATTER. IF NECESSARY, ADD ORGANIC MATTER. USE PURCHASED TOPSOIL TO COMPLETE SPECIFIED REQUIREMENTS IF SUFFICIENT ON-SITE TOPSOIL DOES NOT EXIST. TOPSOIL MUST BE NATURAL, GRAVEL-FREE, FERTILE SOIL CHARACTERISTIC OF PRODUCTIVE SOIL WITHIN THE LANDSCAPE. SOIL SHOULD BE PROTECTED FROM STOCKS AND BE PROTECTED FROM OTHER SOILS. SOIL SHOULD BE WELL ROTTED AND 6-8 PH. ORGANIC MATTER SHALL BE WELL ROTTED.
8. NEW LAWN AREAS SHALL HAVE 4" OF TOPSOIL, RAKED SMOOTH TO FINISH GRADERS. FERTILIZED WITH 5-10-5 AT A RATE OF 30 LBS PER 100 SQ. FT.
9. LAWN SEED MIX: 50% KENTUCKY BLUEGRASS, 30% RED FESCUE, 20% ANNUAL PRE-SOW AT A RATE OF SLBS/1000 SQ. FT.
10. IF UPON INSPECTION, EXISTING USED AS STREET TREES TO REMAIN APPEAR TO BE IN POOR CONDITION OR HEALTH, SAID TREES MUST BE REMOVED AND NEW STREET TREES PLANTED TO REPLACE THEM.
11. CONSTRUCTION OR SILT FENCING MUST BE INSTALLED AROUND EXISTING TREES TO REMAIN WITHIN ANY AREAS OF DISTURBANCE INCLUDING THOSE USED AS STREET TREES.

SYMBOL	QTY	SCIENTIFIC NAME	COMMON NAME	SIZE
AS	2	ACER SACCHARINUM	SUGAR MAPLE	2 1/2"-3" COL.
JM	2	PICER PALMATUM	JAPANESE RED MAPLE	2--2 1/2col.
BX	6	BILYUS SERRIFRONS WINTER GEM	WINTER GEM BOXWOOD	5gal.
C.C.M.	2	CHAMAECYPARIS FILERIA ALYREA	GOLD MOP CYPRESS	3gal.
V.T.	2	VERURUM PLOCATUM SHASTIA	SHASTIA VIBURNUM	3"-3 1/2"

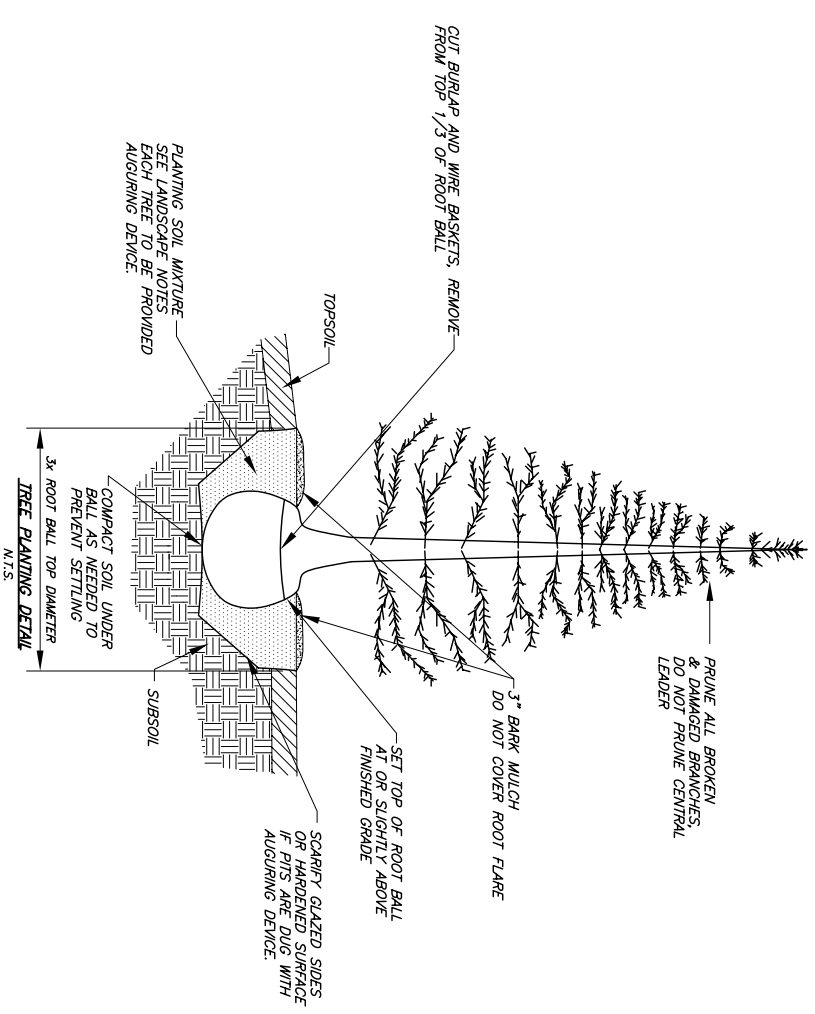

THIS SHEET IS ANNUAL AND VOID UNLESS ACCOMPANIED BY REMAINING SHEETS IN SET.

TALCOTT ENGINEERING DESIGN PLLC

1 GARONERTOWN ROAD
NEWBURGH, N.Y. 12550
(914) 569-8400
(914)(845) 569-4383
TALCOTTDESIGN@BROADWAY.COM

CHARLES T. BROWN, P.E.

P.O. BOX 4470
NEW WINDSOR, N.Y. 12553

REV.	DATE	BY	DESCRIPTION
1	01/31/12	C.B.M.	PER TOWN COMMENTS

SYR PLAN FOR:
CARLOS DOMINGUES
NEW ROAD, S/B/I: 39-1-14
TOWN OF NEWBURGH, ORANGE COUNTY, NY

DATE: 12/23/11
SCALE: 1"=10'
JOB NUMBER: 11114-CDS
SHEET NUMBER: 2 OF 3