

NOTES:

SUBJECT to any easements, rights-of-ways, and/or agreements that the utility companies may have.
 SUBJECT to such facts disclosed by an accurate, up-to-date title search.
 OFFSETS shown hereon are not to be used for construction purposes and/or fence installation.

AREA= 22,500 S.F.
= 0.517± acres

REFERENCES:

TAX MAP DATA:
 Section: 52
 Block: 12
 Lot: 6.2

Deed Liber: 12605 Page: 1486

Being Lots 31, 32, and 33 as shown on a map entitled "Map of Lots Owned by the Orange Lake Land Corporation", said map filed in the Orange County Clerk's office on 8 September 1933 as map number 973.

Survey of Property for
MEJIAS
 located in the
Town of Newburgh
Orange County - New York

I hereby certify to:
 -Daniel Mejias;

that this mapping is based on a field survey performed on the date indicated hereon, deeds and/or maps obtained from the County Clerk's office, and is correct and accurate to the best of my knowledge.

Howard W. Weeden
 Howard W. Weeden, P.L.S., P.C. NYS Lic. No. 049967

Unauthorized alteration or addition to a survey map bearing a licensed land surveyor's seal is a violation of Section 7209, sub-division 2, of the New York State Education Law.

Certifications indicated hereon signify that the survey was prepared in accordance with the existing Code of Practices for Land Surveys adopted by the New York State Association of Professional Land Surveyors. Said certifications shall run only to the person(s) for whom the survey is prepared, and on his/her behalf to the title company, governmental agency and lending institution listed hereon, and to the assignees of the lending institution. Certifications are not transferable to additional institutions or their subsequent owners.

Scale: 1" = 30' date: 15 May 2014 file no.: 14-121

Howard W. Weeden, P.L.S., P.C.

PROFESSIONAL LAND SURVEYING
 62 Main Street, Walden, N.Y. 12586
 tel.: (845) 778-7643

© copyright by Howard W. Weeden, P.L.S., P.C., Walden, New York

Sibbodes Bros. Rear Line

ER-1841

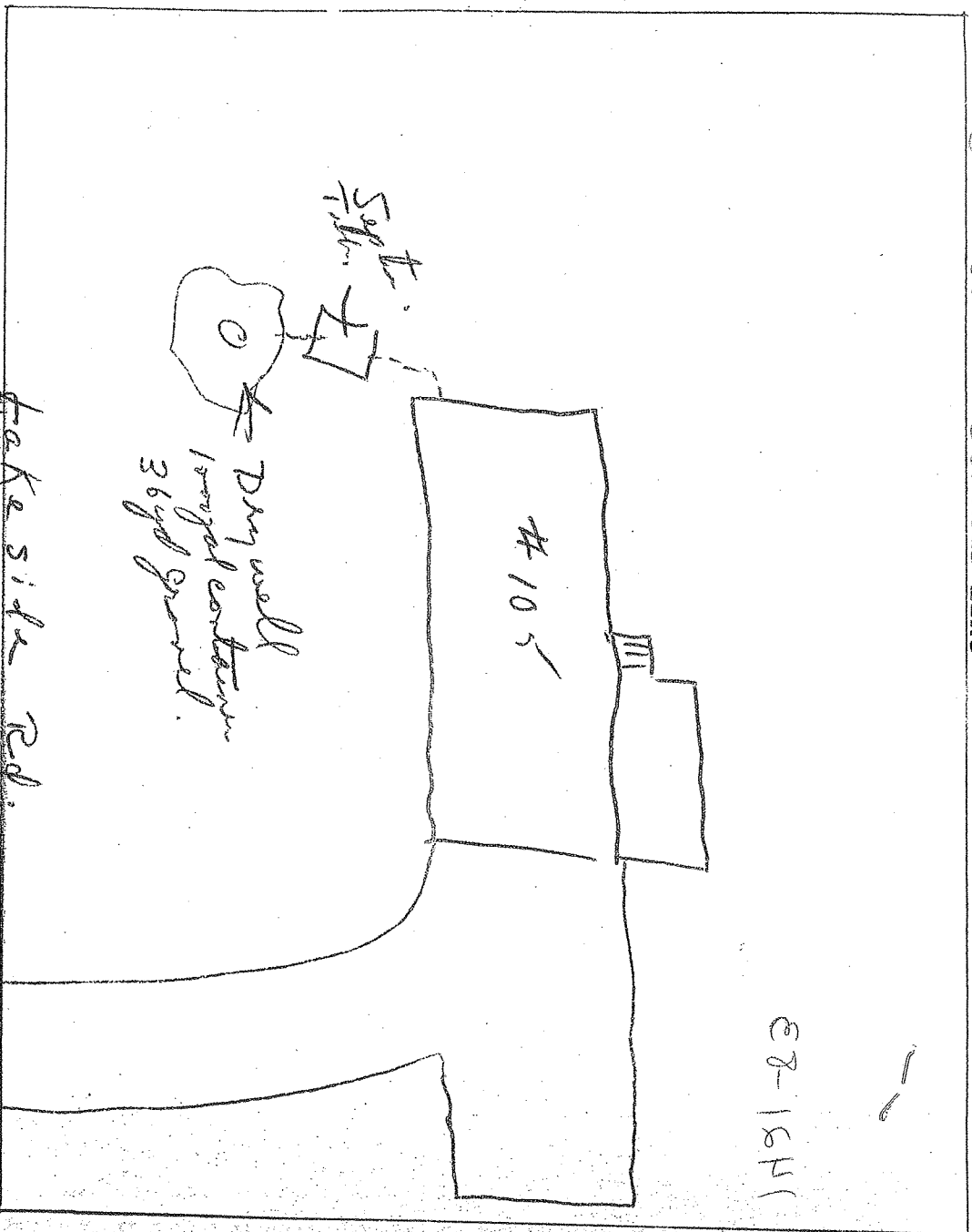

Show Trench depth in section and indicate trench separation in drawing. State and locate if drainage courses exist on property.

46.64: LOCATION OF SYSTEMS IN RELATION TO BUILDINGS, WATER SUPPLY AND OTHER FACILITIES

No septic tank, leaching pit or other device for the storage or disposal of human excreta, sewage, trade wastes or industrial wastes shall be installed unless every part of such installation shall be more than ten (10) feet from the boundary line of the property on which it is located, ten (10) feet from the foundations of any building or drinking water supply line and more than fifty (50) feet from any suction line from a well, lake, reservoir, stream or watercourse; nor shall any such installation be located on the direct line of drainage to not less than fifty (50) feet in a horizontal direction from any well in which the casing extends watertight to a depth of fifty (50) feet or more nor less than one hundred (100) feet in a horizontal direction from any other type well, spring or other source of water supply. No sewer line shall pass closer than twenty-five (25) feet to any well, ten (10) feet to any drinking water supply line, five (5) feet to any basement foundation, and any sewer pipe within fifty (50) feet of any well or spring shall be watertight pipe with lead caulked or equal approved joints.

LATERALS:

FRONT
YARD

SEPTIC TANK
DRAIN
15000
36 YARDS
GRAVEL

House sits on the
PROPERTY on
an angle.

SIDE OF
HOME

DRIVE
WAY

EXISTING
DECK ON
HOUSE

DECK
IS 9 FT

POOL
10 FT
FROM
HOME

SHEED

ABOVE GROUND
POOL
12 FT 9 IN

POOL
12 FT
WIDE

EDGE OF
HOME IS
26.9'

POOL
2 FT
FROM
EXISTING
DECK

POOL
24 FT
LONG

EDGE OF
HOME IS
32 FT 9 INCHES
TO PROPERTY
LINE

POOL IS
6 FT

EDGE OF
EXISTING DECK
IS 2 FT
FROM PROPERTY

PROPERTY LINE