

PROPOSED WATER SERVICE TAP
APPROXIMATE LOCATION
OF EXISTING WATERMAIN
(GRAVEL SURFACE)
BEN'S WAY

LAURIE LANE
(GRAVEL SURFACE)

ADJACENT
PAVED DRIVEWAY

ADJACENT
PAVED DRIVEWAY

PROPOSED WATER SERVICE
1" TYPE K COPPER

PROPOSED DRIVEWAY

CH=S66°33'11"W
7.29'

R=100.00

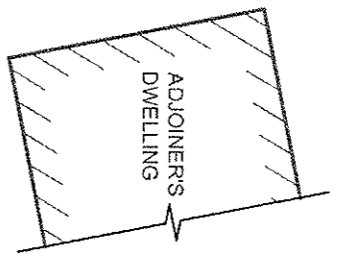

REPUTED OWNER:
DOEHLA
TAX MAP ID: 40-3-4
DEED BOOK: 5425, PAGE: 29
(FILED MAP 1814, LOT 9)

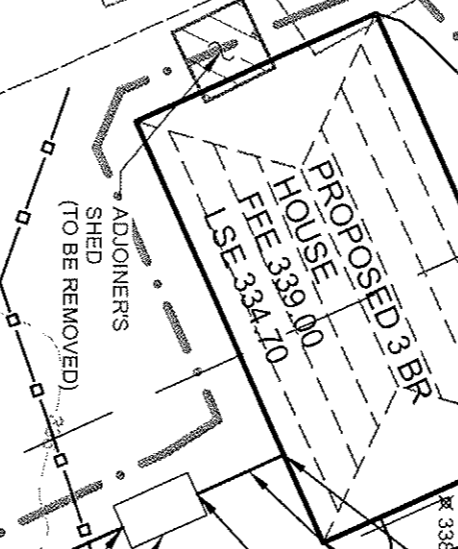

REPUTED OWNER:
NACLERIO
TAX MAP ID: 40-3-2
DEED BOOK: 3388, PAGE: 193
(FILED MAP 1814, LOT 11)

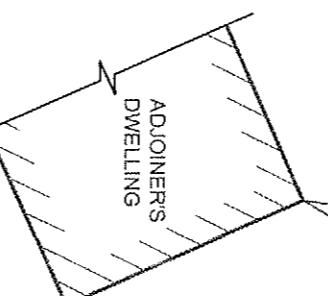

-50' SIDE YARD SETBACK (TYP)

30' SIDE YARD
SETBACK (TYP)

40' REAR YARD
SETBACK (TYP)

AREA:
TAX MAP ID: 40-3-3
17,571 SF
0.403± ACRES

15' WIDE
DRAINAGE
EASEMENT

CLEANOUT
(TYP)

1000 GALLON SEPTIC TANK

174 LF @ 1.5%
(TOTAL)

11' 10" 3/4"

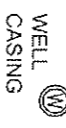

AREA:
TAX MAP ID: 40-3-10
17,483 SF
0.401± ACRES

PROPOSED GRASSSED SWALE

REPUTED OWNER:
SQUARCI
TAX MAP ID: 40-3-11
DEED BOOK: 13026, PAGE: 1851
(FILED MAP 1814, LOT 2)

PROPOSED 15'
DRAINAGE EASEMENT

4 LINES OF
6 ELIEN MODULES
(96 LF TOTAL)

50' SIDE YARD
SETBACK (TYP)

15' WIDE
DRAINAGE
EASEMENT
(TO BE RELOCATED)

REPUTED
SEPTIC AREA

ADJOINERS
DWELLING

ADJOINERS
DWELLING

REPUTED

REPUTED OWNER:
NACLERIO
TAX MAP ID: 40-3-2
DEED BOOK: 3388, PAGE: 193
(FILED MAP 1814, LOT 11)

REPUTED OWNER:
SQUARCI
TAX MAP ID: 40-3-11
DEED BOOK: 13026, PAGE: 1551
(FILED MAP 1814, LOT 2)

AREA:
TAX MAP ID: 40-3-3
17,571 SF
0.403± ACRES

AREA:
TAX MAP ID: 40-3-10
17,483 SF
0.401± ACRES

REPUTED OW
BANKE
TAX MAP ID: 4
DEED BOOK: 11363,
(FILED MAP 1814,

