

Full Size Site Plans

are available for viewing at the

Zoning Board of Appeals

Office located at

308 Gardnertown Road

Newburgh, NY

845-566-4901

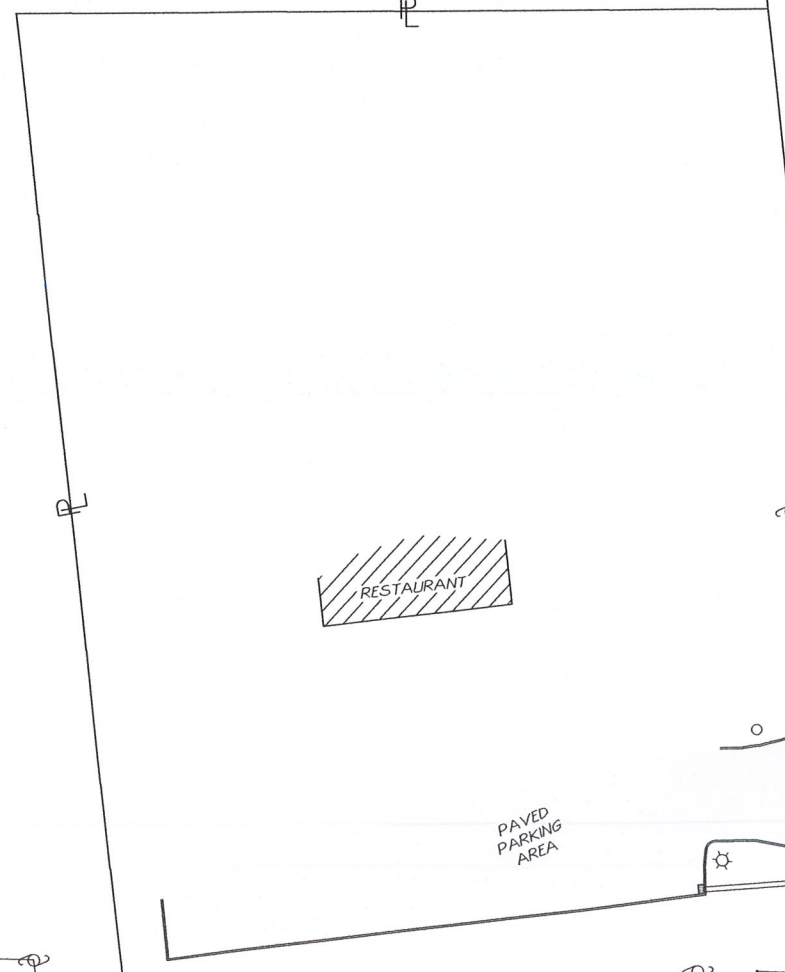
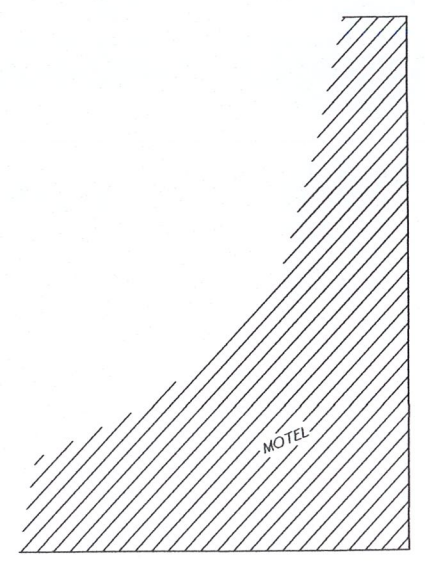
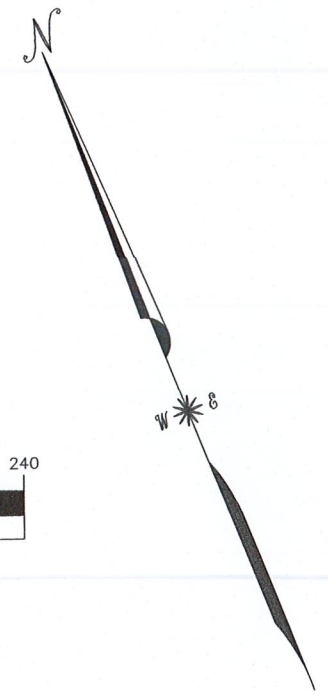
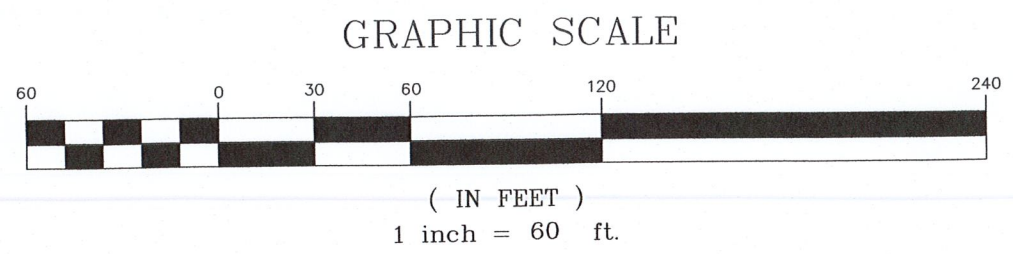
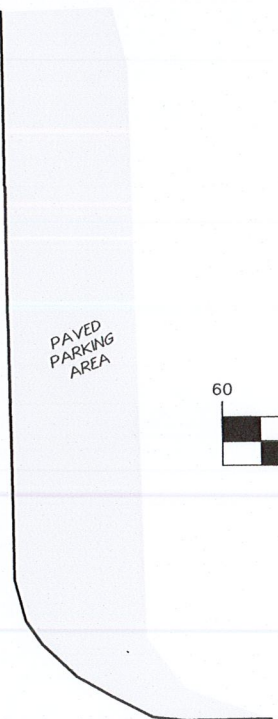

16" CAST IRON WATER MAIN

e 300

New York State Thruway
CATSKILL SECTION SUBDIVISION 5
MAP # 675, PARCEL # 675
LIBER 11389, PAGE 1201
SEE NOTE 2.

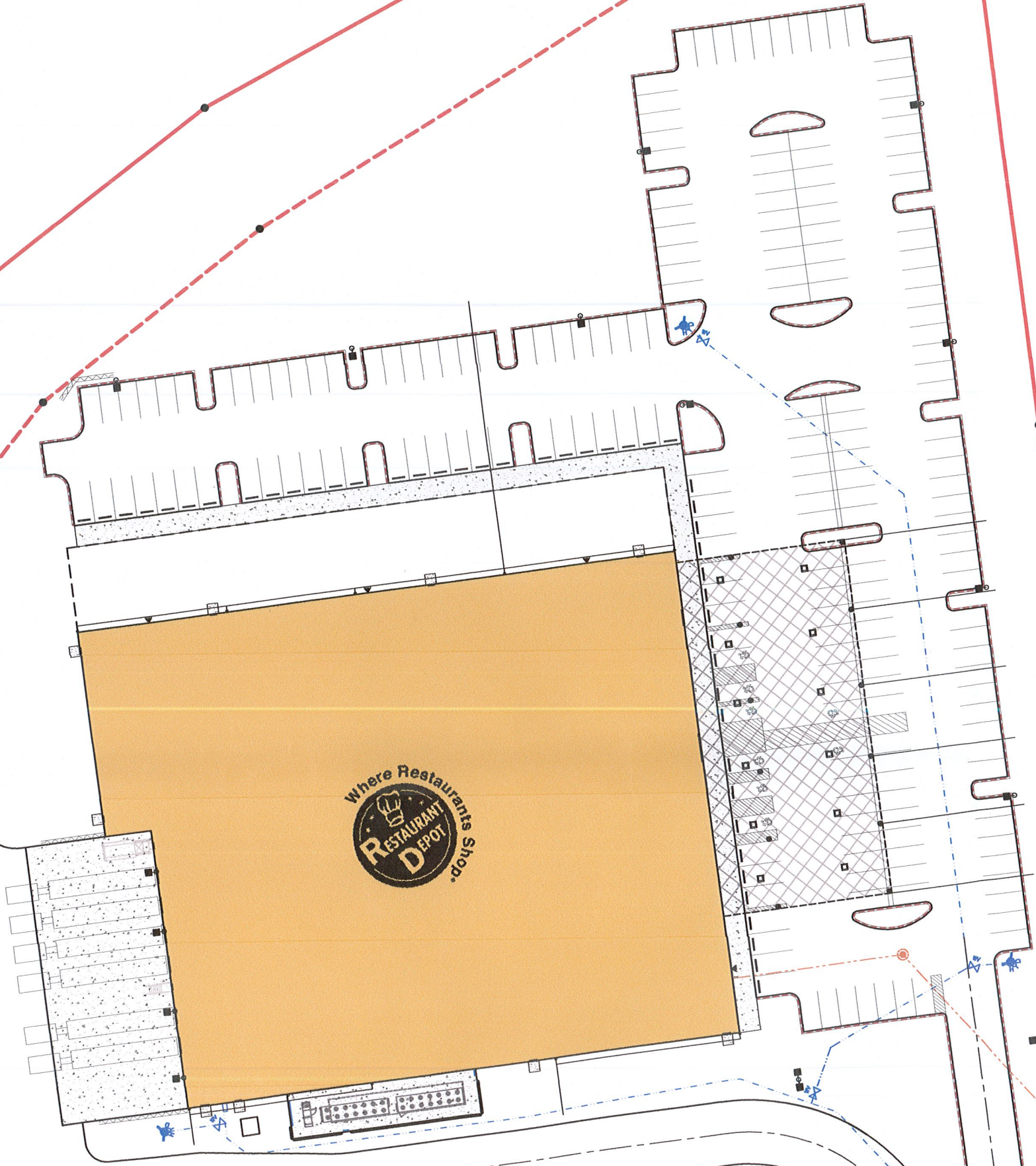

PAVED
PARKING
AREA

60

PAVED
PARKING
AREA

New York State Thruway

GATSKILL SECTION SUBDIVISION 5
MAP # 675, PARCEL # 675
LIBER 11389, PAGE 1201
SEE NOTE 2.

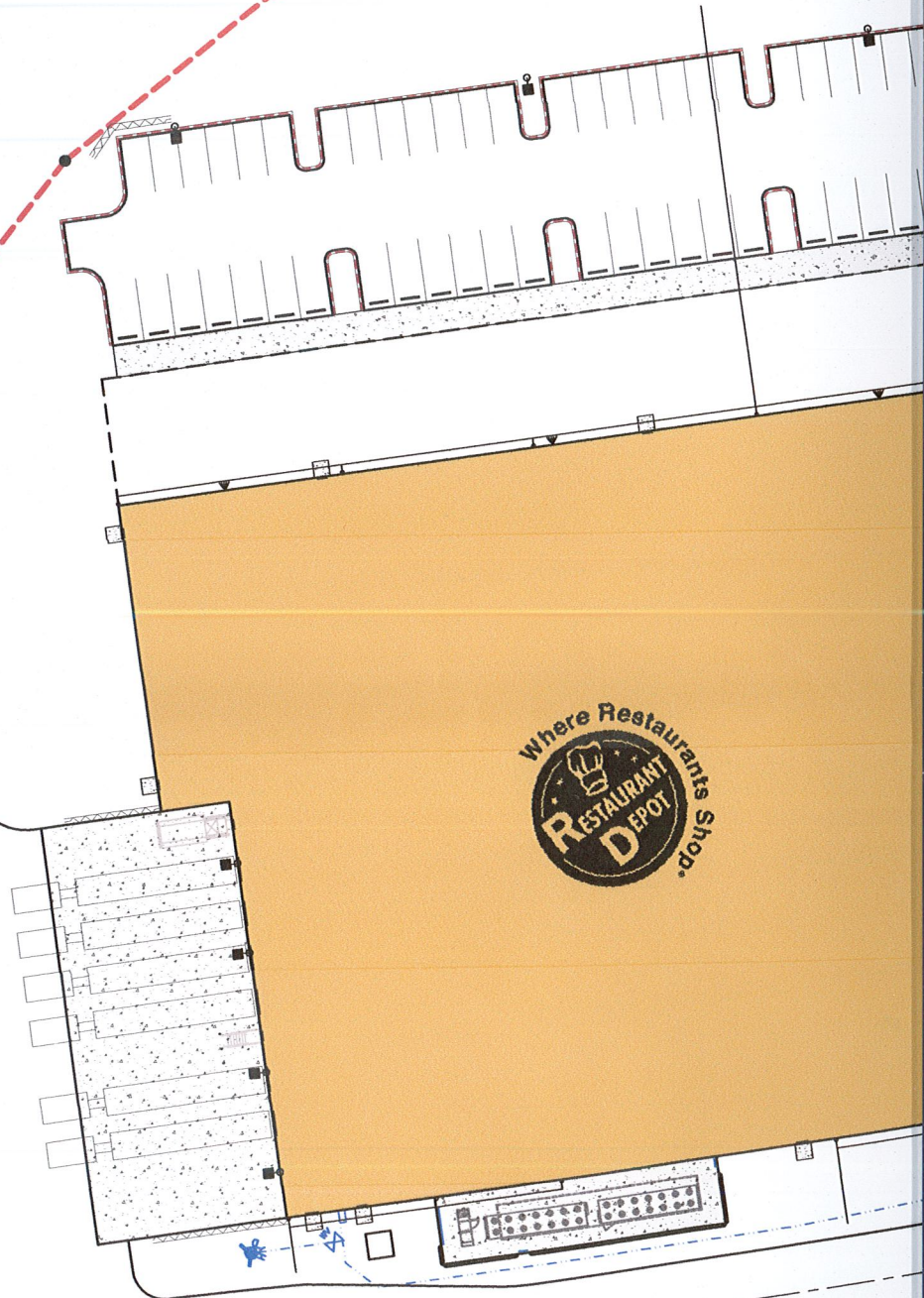

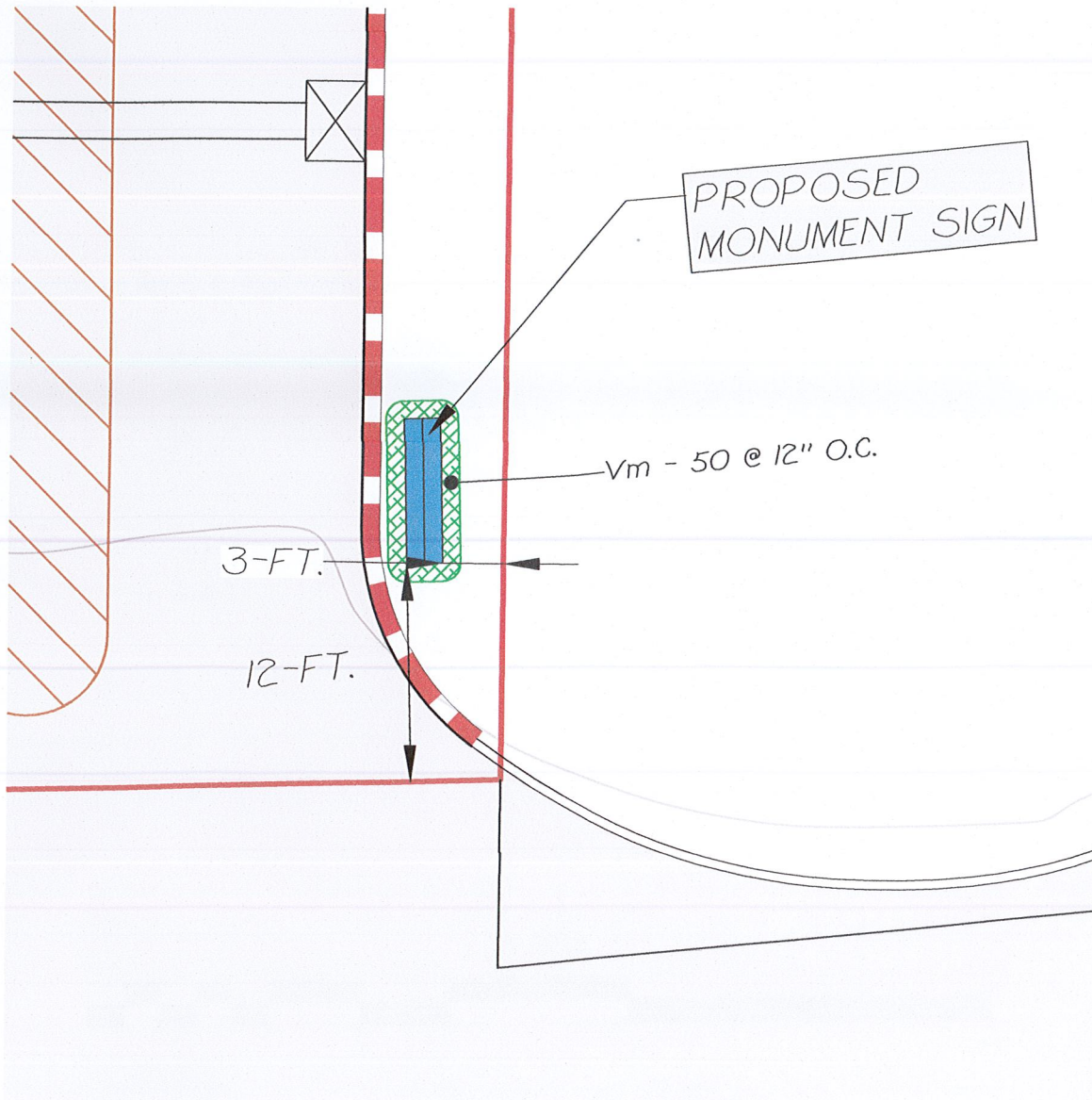

Planting Table

COMMON NAME	BOTANICAL NAME	KEY	QTY	PLANTING SIZE	MATURE SIZE	TYPE
PERIWINKLE	VINCA MINOR	Vm	50	3.5" CAN	3" - 6"	GROUND COVER

Sign Landscaping Plan

SCALE: 1" = 10'

TOWN OF NEWBURGH PROJECT #2015-33

Monument Sign Detail for Site Plan for Jetro Cash & Carry Enterprises, Inc.

RECORD OWNER: ROUTE 300 NEWBURGH PARTNERS, LLC 1277 UNION AVENUE, NEWBURGH, NY 12550
DEED REFERENCE: LIBER 11820, PAGE 1772
TAX MAP REFERENCE: SECTION 95, BLOCK 1, LOT 8

Situate in the Town of Newburgh
Orange County, New York State
Scale As Noted November 2015

on-Tarolli-Marshall
LAND SURVEYING

in Street; Pine Bush, NY 12566
744.3805 Email: mntm@mntm.co

NO.	DATE	DESCRIPTION	BY

LAWRENCE MARSHALL PE #087107

DRAFTED BY:

MAP CK:

etail

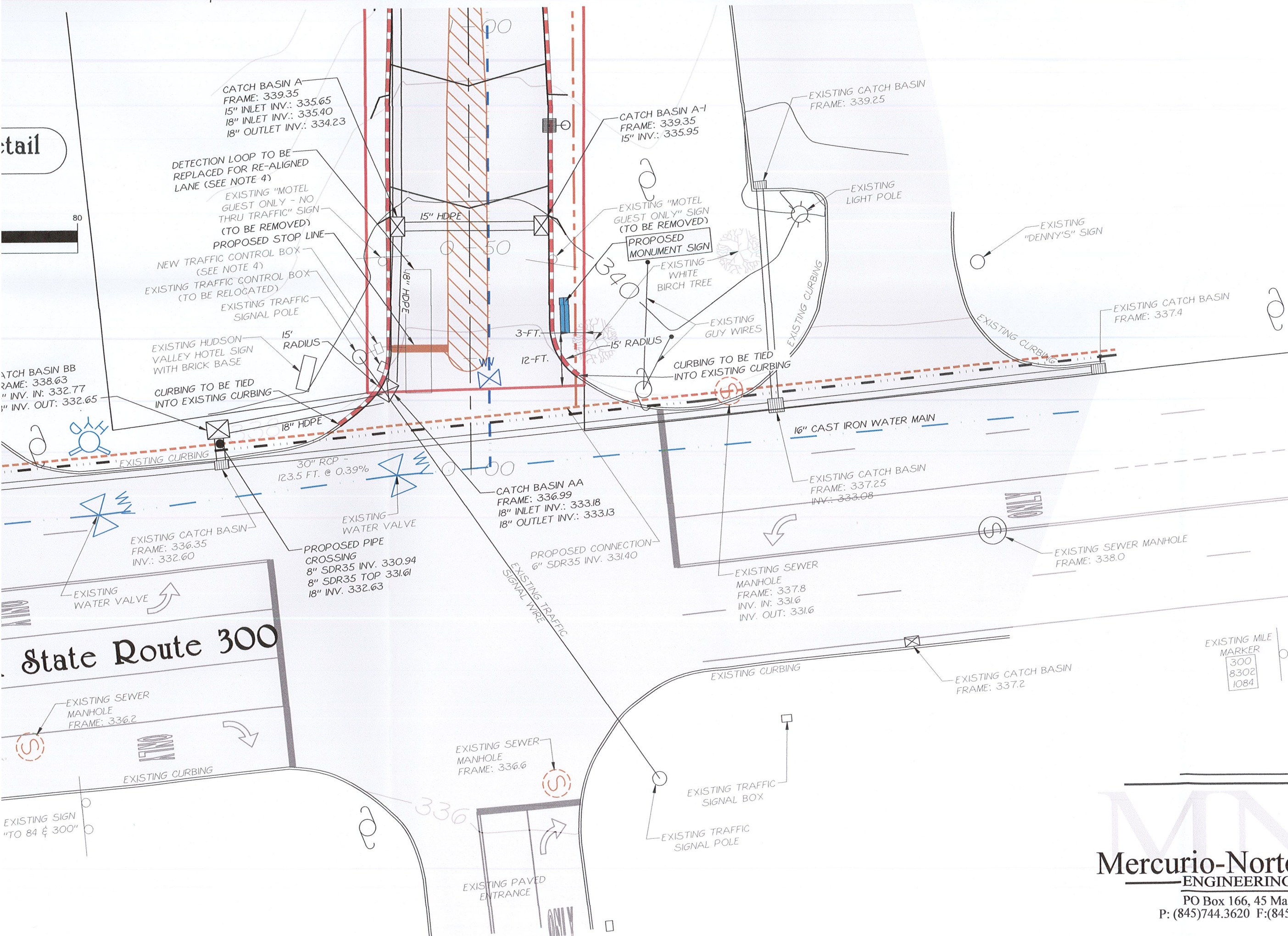
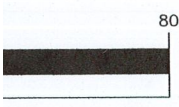

State Route 300

MNTM
Mercurio-Norton-Tarolli-Mars
 ENGINEERING - LAND SURVEYING

PO Box 166, 45 Main Street, Pine Bush, NY 12566
 P: (845)744.3620 F:(845)744.3805 Email: mntm@mntm.co

Monument Sign Location Detail

SCALE: 1" = 20'

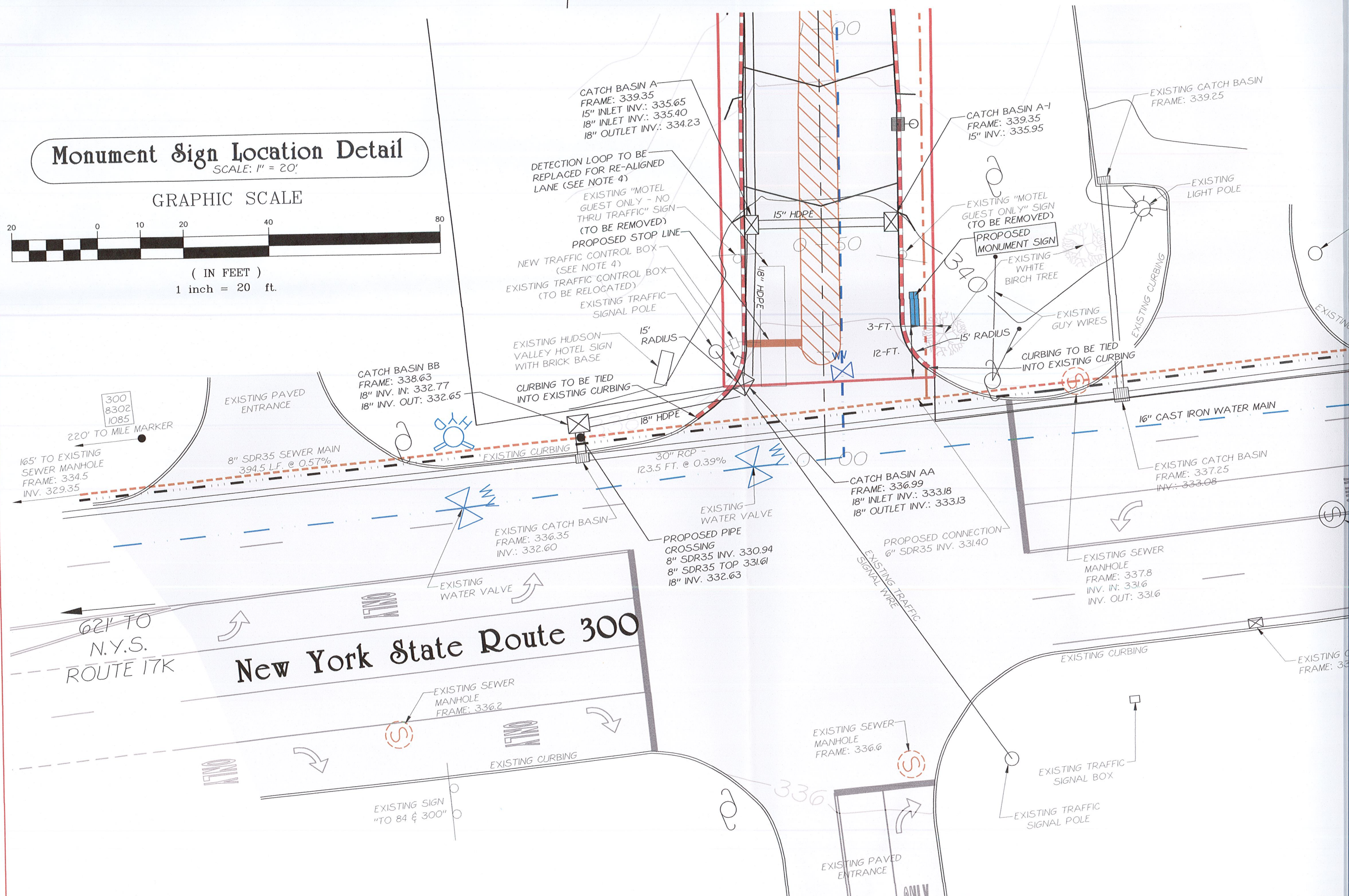
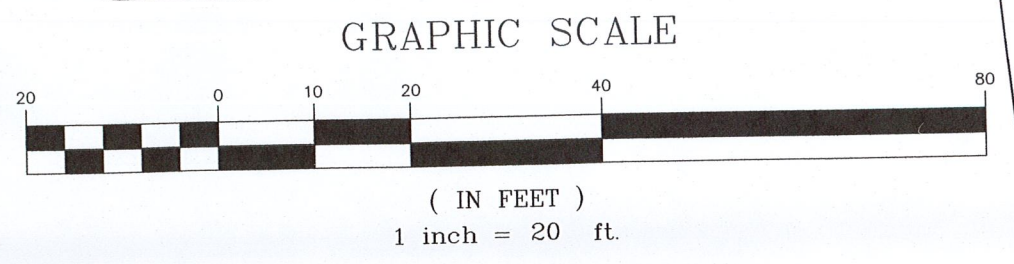

CATCH BASIN A
FRAME: 339.35
15" INLET INV.: 335.65
18" INLET INV.: 335.40
18" OUTLET INV.: 334.23

CATCH BASIN A-1
FRAME: 339.35
15" INV.: 335.95

EXISTING CATCH BASIN
FRAME: 339.25

DETECTION LOOP TO BE
REPLACED FOR RE-ALIGNED
LANE (SEE NOTE 4)

EXISTING "MOTEL
GUEST ONLY - NO
THRU TRAFFIC" SIGN
(TO BE REMOVED)
PROPOSED STOP LINE

NEW TRAFFIC CONTROL BOX
(SEE NOTE 4)
EXISTING TRAFFIC CONTROL BOX
(TO BE RELOCATED)
EXISTING TRAFFIC
SIGNAL POLE

EXISTING HUDSON
VALLEY HOTEL SIGN
WITH BRICK BASE
15'
RADIUS

EXISTING "MOTEL
GUEST ONLY" SIGN
(TO BE REMOVED)
PROPOSED
MONUMENT SIGN

EXISTING
WHITE
BIRCH TREE

EXISTING
GUY WIRES

CURBING TO BE TIED
INTO EXISTING CURBING

CATCH BASIN BB
FRAME: 338.63
18" INV. IN: 332.77
18" INV. OUT: 332.65

CURBING TO BE TIED
INTO EXISTING CURBING

300
8302
1085
220' TO MILE MARKER
165' TO EXISTING
SEWER MANHOLE
FRAME: 334.5
INV. 329.35

EXISTING PAVED
ENTRANCE
8" SDR35 SEWER MAIN
394.5 LF. @ 0.57%

30" RCP -
123.5 FT. @ 0.39%

16" CAST IRON WATER MAIN

EXISTING CATCH BASIN
FRAME: 337.25
INV.: 333.08

CATCH BASIN AA
FRAME: 336.99
18" INLET INV.: 333.18
18" OUTLET INV.: 333.13

EXISTING CATCH BASIN
FRAME: 336.35
INV.: 332.60

EXISTING WATER VALVE
PROPOSED PIPE
CROSSING
8" SDR35 INV. 330.94
8" SDR35 TOP 331.61
18" INV. 332.63

PROPOSED CONNECTION
6" SDR35 INV. 331.40

EXISTING SEWER
MANHOLE
FRAME: 337.8
INV. IN: 331.6
INV. OUT: 331.6

621' TO
N.Y.S.
ROUTE 17K

New York State Route 300

EXISTING SEWER
MANHOLE
FRAME: 336.2

EXISTING SEWER
MANHOLE
FRAME: 336.6

EXISTING SIGN
"TO 84 & 300"

EXISTING TRAFFIC
SIGNAL BOX
EXISTING TRAFFIC
SIGNAL POLE

EXISTING PAVED
ENTRANCE