

OFF-SITE NOTES

1. ALL WORK IN STATE RIGHT OF WAY SHALL BE IN ACCORDANCE WITH N.Y.S. STANDARDS AND SPECIFICATIONS. THIS INCLUDES BUT IS NOT LIMITED TO STRIPING, CURBING, PAVEMENT REPAIR, STRIPING REMOVAL, DRAINAGE IMPROVEMENTS.

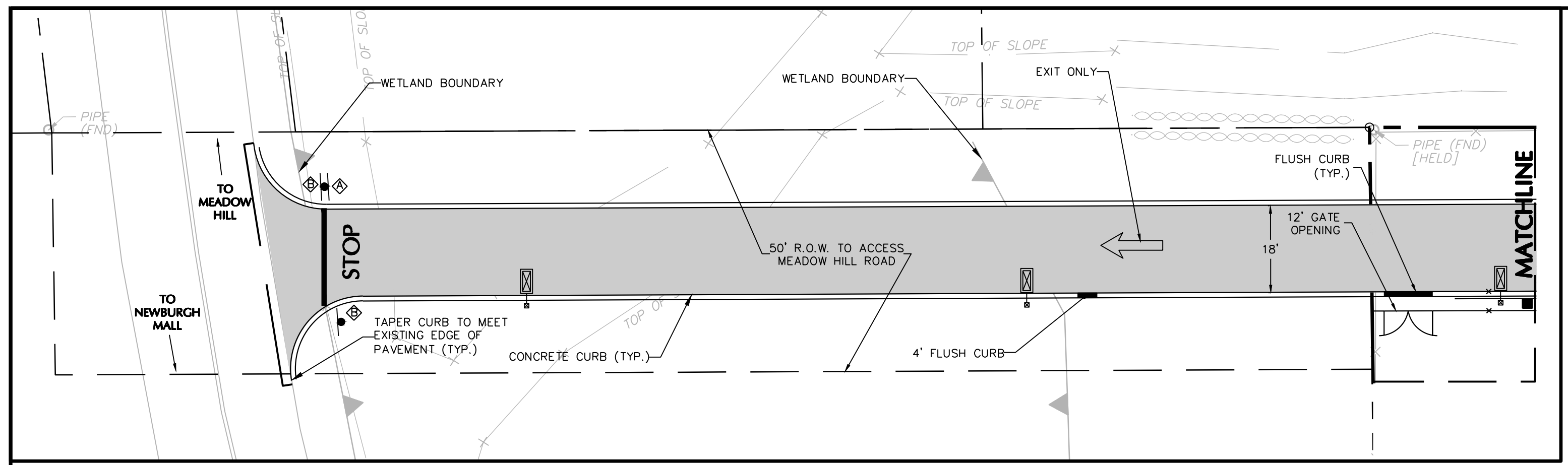

ACCESS DRIVE TO MALL ROADWAY AND MEADOW HILL

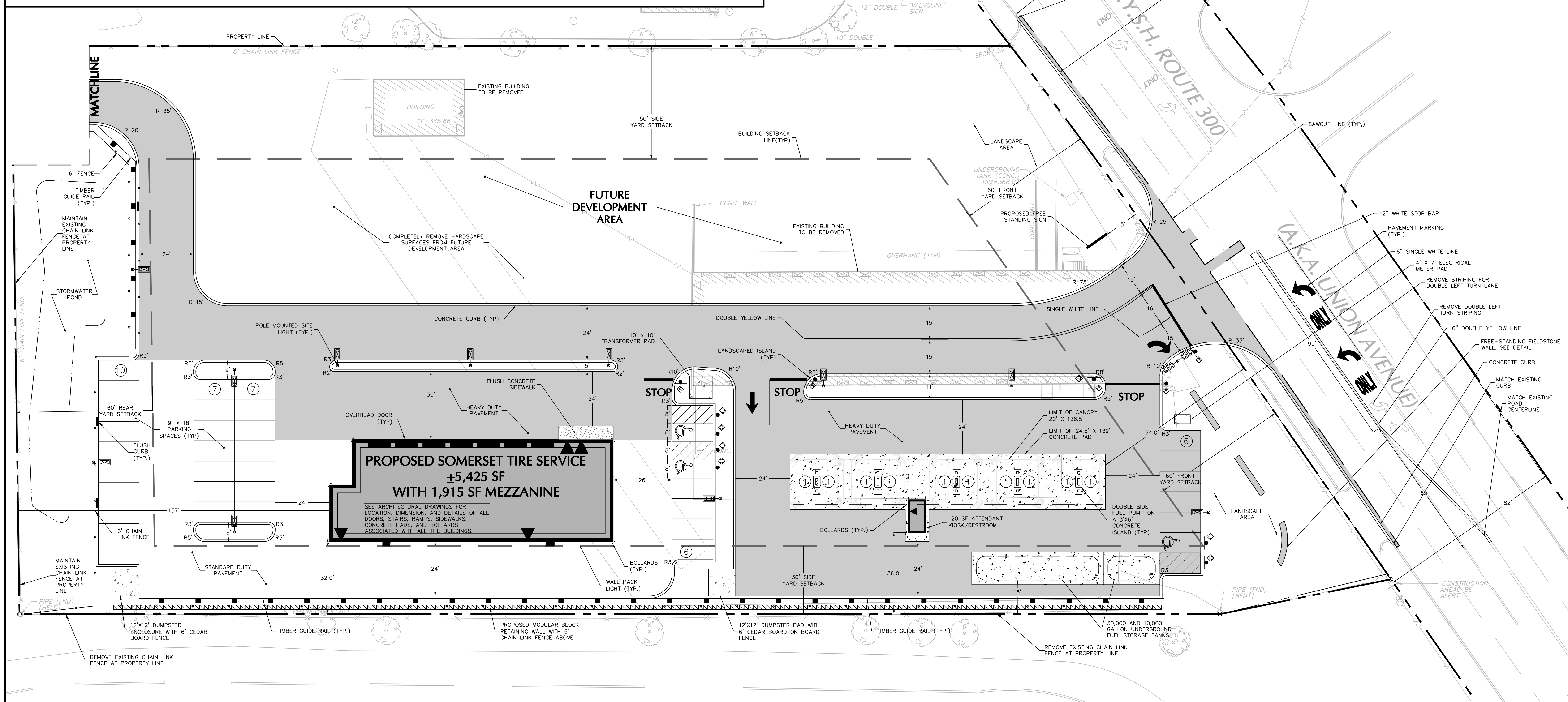

PROPOSED SOMERSET TIRE SERVICE
 ±5,425 SF
 WITH 1,915 SF MEZZANINE

SEE ARCHITECTURAL DRAWINGS FOR LOCATION, DIMENSION, AND DETAILS OF ALL DOORS, STAIRS, RAMPS, SIDEWALKS, CONCRETE PADS, AND BOLLARDS ASSOCIATED WITH ALL THE BUILDINGS.

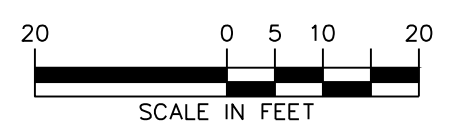

Warning: It is a violation of the NYS Education Law Article 145 for any person, unless he is acting under the direction of a licensed Professional Engineer, to alter this item in any way.

Date	Description	No.
10/18/12	PLANNING BOARD SUBMISSION	2
4/4/12	ZONING BOARD OF APPEALS SUBMISSION	1
	Revisions	

JOHN D. PLANTE
 PROFESSIONAL ENGINEER NY Lic. No. 090145-1

LANGAN
 ENGINEERING & ENVIRONMENTAL SERVICES

555 Long Wharf Drive
 New Haven, CT 06511-6107
 P: 203.562.5771 F: 203.789.6142
 www.langan.com

NEW JERSEY PENNSYLVANIA NEW YORK CONNECTICUT FLORIDA
 NEVADA VIRGINIA CALIFORNIA

Project
ROUTE 300 CENTER
 1413 UNION AVENUE
 NEWBURGH
 NEW YORK

Drawing Title
SITE PLAN

Project No. **140059701**
 Date **2/1/2012**
 Scale **1"=20'**
 Drn. By **RS**
 Checked By **TSO**

Drawing No.
CS101-0101